

Z86/...

DIN 3017-1

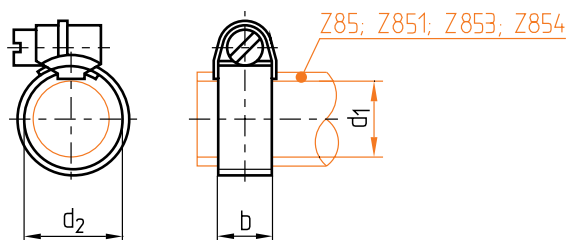

b	min. d ₂	max. d ₂	d ₁	Nr./No.
9	10	16	9	Z86/ 9
12	12	20	13	13
	20	32	19	19

Z861/...

Mat.: 1.0333



► Info

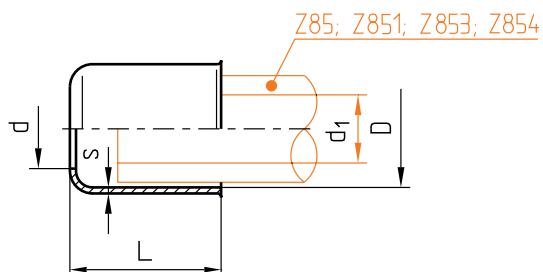

S	L	d	d ₁	D	Nr./No.
0,8	20	11,3	9	16	Z861/ 9/16
0,9	26	14,5	13	19,5	13/19,5
	32	17		22	13/22
			22	19	28